

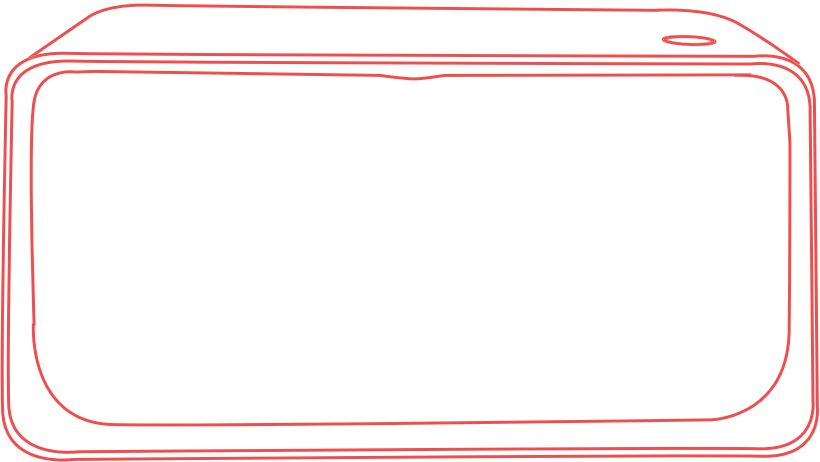

---

## Quick Guide



# What's Included?

---

Qcut Machine Body

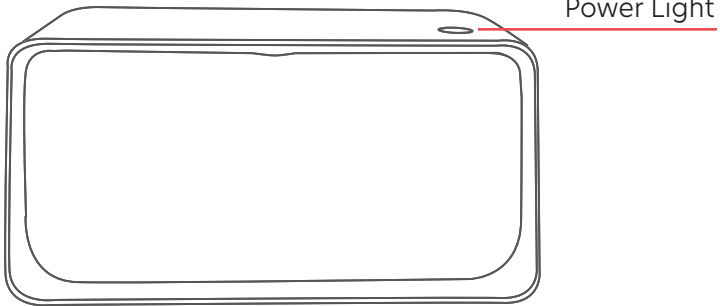

Power Cable

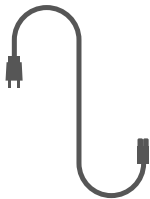

Power Adapter

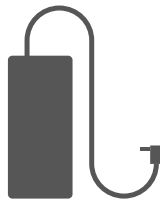

Sample Vinyl x1



# Important Safety Instruction

For your own safety, the safety of others and to prevent damage to the Qcut machine, it is important that this manual be read and understood by all operating the machine.

This appliance is not intended for use by persons (including children) with reduced physical, sensory or mental capabilities, or lack of experience and knowledge.

Qcut machine is designed for adult use only. It is not a toy. During operation keep children and pets away from the machine.

When replacing the cutting blade ensure the machine is turned off and unplugged from the electrical outlet.

Ensure machine is used and stored indoors in a dry area away from moisture.

When not in use the machine should be turned off and unplugged from the electrical outlet.

The outside casing can be cleaned with a light damp cloth.

Only use the Qcut machine with its own power adapter. Using other adapters can create a fire risk.

## CAUTION!

Beware of sharp cutting blade. Do NOT put your fingers onto sharp edges or into the machine

## Quick Setup

*\*Qcut will need a smartphone with bluetooth function to operate.*

1. Download the Qcut Design App from the App store on your smartphone.



Make sure to turn on the bluetooth and agree to let Qcut app access your current location and Bluetooth.

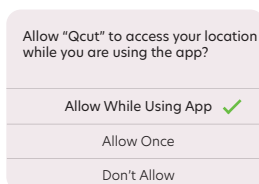

2. Make sure that you plug in the machine to the power outlet and the switch light is on
3. Follow the steps on the App to connect to your Qcut Machine.
4. You are ready to create with Qcut now.

## 24 Month Warranty

Our goods come with guarantees that cannot be excluded under the Australian Consumer Law.

- You are entitled to a replacement or refund for a major failure and compensation for any other reasonably foreseeable loss or damage.
- You are also entitled to have the goods repaired or replaced if the goods fail to be of acceptable quality and the failure does not amount to a major failure.

### Where is this warranty applicable

**This warranty is applicable in Australia only**

### What is covered

This warranty applies against any defects or workmanship of the product for a period of 24 months from the date of purchase for domestic use only. The warranty is non-transferable and proof of purchase is required to make a claim.

### What is not covered

**Consumable items including Cutting Blade, Cutting Mat are not covered under warranty.**

This warranty does not apply to any incidental/indirect/consequential malfunction, defect, deterioration, loss, damage, destruction, death or injury as a result of:

- *Operation/use of the product not in accordance with the user manual*
- *Unauthorised disassembly, dismantling, tampering, repair or service*
- *Misuse, abuse or negligent handling*
- *Fire, flood, natural disasters, "acts of god" and accidents beyond our control.*
- *Commercial use of the product.*

Support Centre  
*Create@Qcut.design*

Supplied by Charti Pty Ltd.  
9 Fink St, Williamstown North  
3016 VIC